

कार्यपालक अभियन्ता का कार्यालय
ग्रामीण कार्य विभाग कार्य प्रमंडल, बाँका-1

पत्रांक...1903अगुबाँका-1

दिनांक :-21/12/2021

प्रेषक,

कार्यपालक अभियन्ता,
ग्रामीण कार्य विभाग,
कार्य प्रमंडल, बाँका-1

सेवा में,

नोडल पदाधिकारी MR 3054,
ग्रामीण कार्य विभाग,
बिहार, पटना।

विषय : MR 3054 New Maintenance Policy 2018 के अन्तर्गत आवंटन की अधियाचना के संबंध में।

महाशय,

उपर्युक्त विषय के संबंध में कहना है कि MR 3054 New Maintenance Policy 2018 के अन्तर्गत पथों में कराये जा रहे कार्यों के भुगतान हेतु अधियाचना विहित प्रपत्र में उपयोगिता प्रमाण-पत्र सहित समर्पित किया जा रहा है।

अनुरोध है कि आवंटन उपलब्ध कराने हेतु अग्रेतर एवं आवश्यक कार्रवाई करने की कृपा की जाय।

अनु०-यथोक्त।

विश्वासभाजन

21/12/21

कार्यपालक अभियन्ता

ग्रामीण कार्य विभाग

कार्य प्रमंडल, बाँका-1

Amid
21/12/21

Requisition Format for Scheme Head - MR (3054) Under Bihar Rural Road maintenance Policy 2018 (Initial Rectification and Surface Renewal)
Name of Division : Banka-1

Sl. No	Package no.	Name of Road	Project ID as per MIS	Administrative Approval (AA) Letter No. & Date	Administrative Approval (AA)		Agreement Amount (in Lac)		Agreement No. & Date	Date of Completion as per Agreement	Actual Date of Completion	Value of IRI (in mm/km)	Thickness of Bitumen Layer (in mm)	Value of Bitumen Content in percentage	Previous Total Allocated Amount (Lac)	up to date expenditure as per MIS (in Lac)	Requisition Against work done (in lac)	Remarks
					Length (in km)	Amount (in Lac)	Initial Rectification with Surface Renewal (in lac)	5 years Routine Maintenance (in lac)										
1	RM/BA/BAN/21/0001	Impt. of Rampur Ramraiya RCD Road to Chhattar.	20703501022	5270/04-10-2019	0.660	14.634	13.804	6.22887	03MBD/2021-22/Date 05.11.2021	04.05.2022	-	2810/3.95	25 mm	5%	0.000	0.000	13.38182	Physically Completed

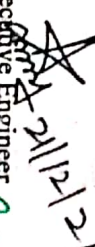
 Executive Engineer
 RWD Works Division
 Banka-1
 21/12/21

FORM GFR 19-A
(See Government of India's Decision (I) below Rule-150
Form of Utilization Certificate up to the month 21.12.2021
MR New Policy 2018

PIU - R.W.D. Works Division Banka-1

Sl. No.	Name of Scheme	Sanction No. & Date with Amount (in lacs Rs.)	Amount Received (in Lacs Rs.)	Particulars
1.	Construction of Rural Roads under MR New Policy 2018	CFMS Letter No - 67 WE, Dt- 15.12.2021	6235.88075	Certified that out of Rs. 6235.88075 Lacs received upto the years 2021-22 in favour of Ex. Engineer, RWD Bihar, Banka-1 a sum of Rs. 6028.89177 lacs has been utilized for the purpose of MR New Policy 2018 Schemes as given in the margin for 206.98898 Lacs remaining unutilized at the end of the period under.
	Total		6235.88075	

2. Certified that I have satisfied may self that the conditions on which the grants in aid was sanctioned have been duly fulfilled/ are being fulfilled and that I have exercised the following checks to see that the money was actually utilized for the purpose for which it was sanctioned.

Kinds of Checks exercised-

- Works have been supervised by Executive Engineer/Superintending Engineer
 - Periodical inspection has been conducted by Executive engineer/Superintending Engineer
 - Construction materials have been tested.
 - Measurements have been recorded in the MBs and test check conducted by the Assistant Engineer / Executive Engineer
 - All other codal formalities have been observed.
- Physical Progress achieved-
 - Construction of Road Works
 - Construction of C.D. Works

Sr. Divisional Accounts Officer
Work Division
Rural Works Department
Banka 1

Executive Engineer
Works Division
Rural Work Department
Banka-1

21/12/21

21/12/21

Date	Time	Section No.	Length in km	Bumps in mm	Speed Rate	OR mm/km	UIV	TEGORY ROAD	IRI	Latitude	Longitude	Event
16/12/21	4:31:23	68	0.1	310	0	3100	2970 G		5.25	24.98248	86.7998	Normal
16/12/21	4:31:55	68	0.1	340	20.2	3400	3369 G		4.46	24.98324	86.79939	Curve
16/12/21	4:32:19	68	0.1	230	30.3	2300	2303 G		3.18	24.98408	86.79943	Normal
16/12/21	4:32:41	68	0.1	240	20.2	2400	2400 G		3.3	24.98497	86.79959	Normal
16/12/21	4:33:10	68	0.1	250	30.3	2500	2497 G		3.42	24.98551	86.80008	Curve
16/12/21	4:33:33	68	0.1	290	20.2	2900	2884 G		3.88	24.98563	86.80099	Curve
16/12/21	4:34:5	68	0.1	310	20.2	3100	3078 G		4.12	24.9864	86.80137	Curve
16/12/21	4:34:28	68	0.1	300	30.3	3000	2981 G		4	24.98671	86.80168	Normal
Total									22482			31.61
Average									2810	G		3.95

Name of Road- Rampur Ramsaraiya RCD Road to Chhattar
Contractor Name- Manikant Singh

CAWY
21/12/2021
NE

Ritom
21/12/21
NE

Executive Engineer
RWD (W) Division, Banka-1
21/12/21

21/12/21

$Y = 0 \cdot X^2 + 0.969 \cdot X + 74.60$
 $X = 21053$
 $Y = 20474$
(R) RURAL ROAD
Good Average Poor
<4000 4001-5000 >5001

Lab Job number :
Date :16-12-2021

Name of Customer :Manikant Singh
Name of Work/ Road :Rampur Ramsaraiya RCD Road to Chhattar

Sr.no	Location of test(in km)	Corrected U.I value(mm/km)	Road catagory
1	0.1	2970	G
2	0.2	3369	G
3	0.3	2303	G
4	0.4	2400	G
5	0.5	2497	G
6	0.6	2884	G
7	0.7	3078	G
8	0.8	2981	G
Total		22482	
Average		2810	G

Chhat
21/12/2021
NE

Pritam
21/12/21
A.E

Star 21/12/21
Executive Engineer
RWD (W) Division, Banka-1

Anil
21/12/21

File : C:\Users\itman\Desktop\Rampur Ramsaraiya RCD Road to Chhatta\19021138.Xls. Section No. : 68. Egn : Y =
 Name of Customer : Manikant Singh. Name of Work/ Road : Rampur Ramsaraiya RCD Road to Chhatta. Lab Job

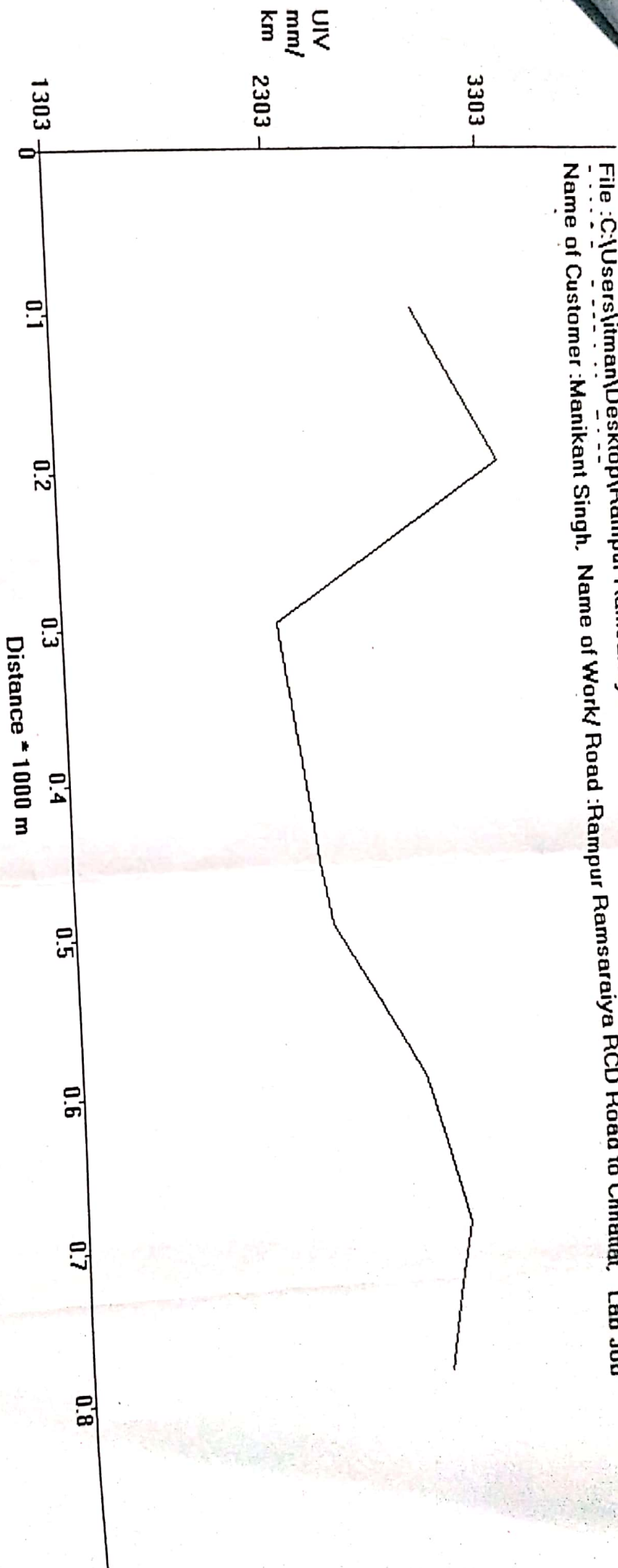

Manikant
 21/12/21

Lab Job
 21/12/2021
 JIS

Ph. 10m
 21.12.21
 A/E

Manikant
 21/12/21

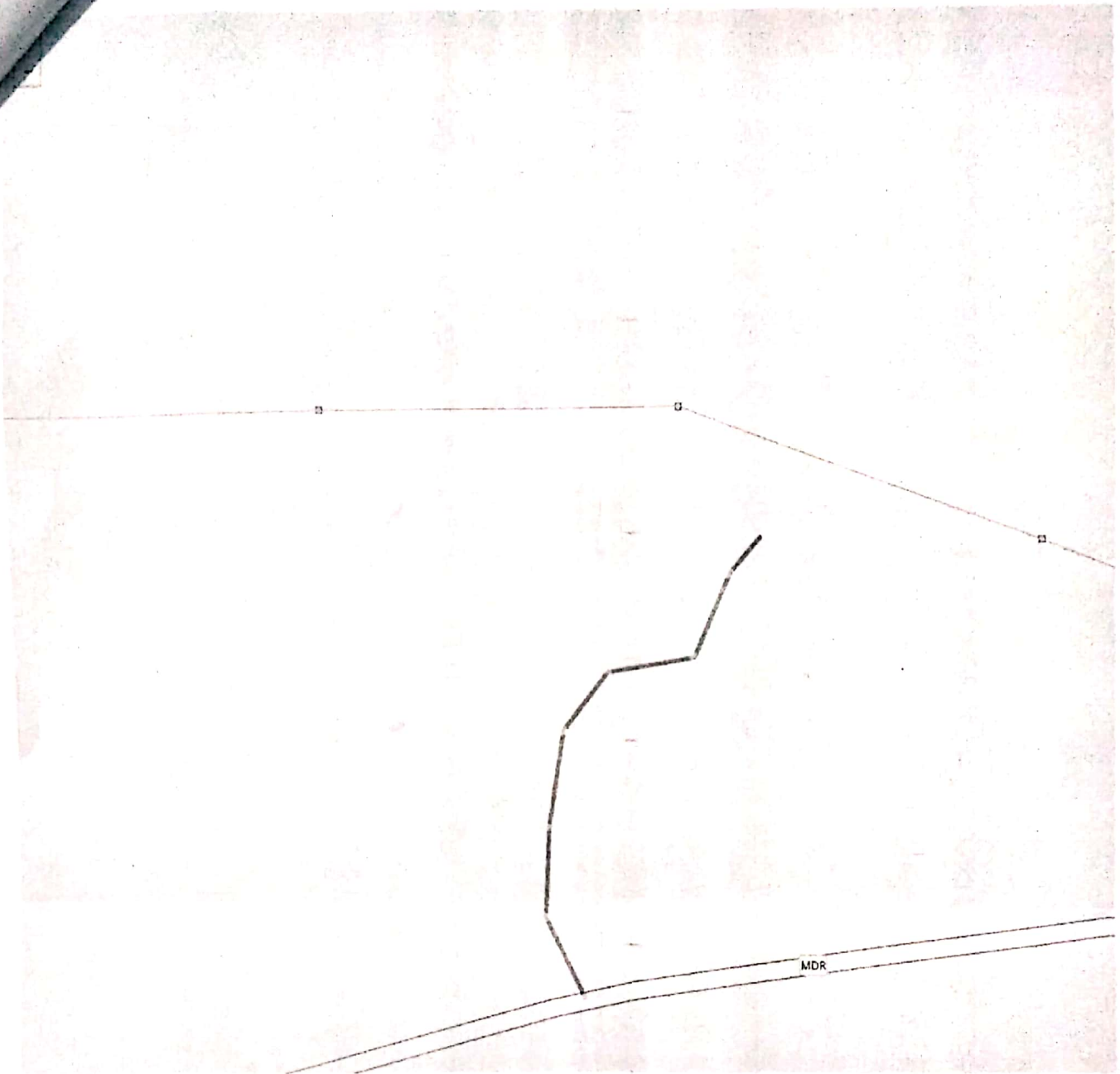

Amit
21/12/21

Lalji
21/12/2021
JE

Pritam
21.12.21
A.E

Star 21/12/21
EE

Executive Engineer
R.W.D. Works Division
BANKA-1